

**TWM – TORUS Water Meter**

Specifications

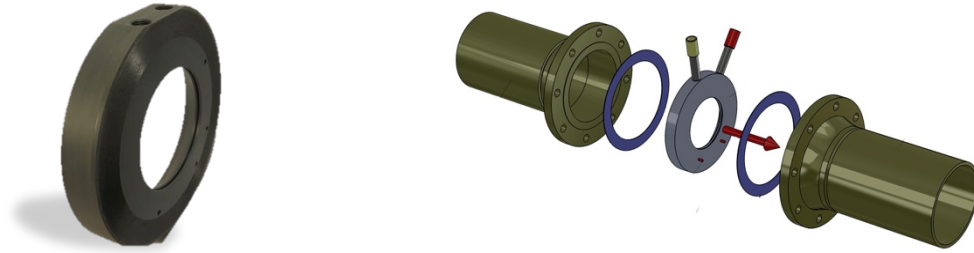

<b>Pipe Sizes</b>		3", 4", 6", 8", 10", 12"		
<b>Flanges/Coupling</b>		150# ANSI Pattern		
<b>Pressure</b>		150 psi (10.3 bar) line pressure		
<b>Temperature</b>	<b>Body</b>	10 <sup>0</sup> to 130 <sup>0</sup> F (-12 <sup>0</sup> to 54 <sup>0</sup> C)		
	<b>Electronics</b>	-40 <sup>0</sup> to 150 <sup>0</sup> F (-40 <sup>0</sup> to 70 <sup>0</sup> C)		
<b>Accuracy</b>		+/- 1.0% Full scale		
<b>Display</b>	<b>Type</b>	128 x 64 dot matrix LCD		
	<b>Digits</b>	<b>5-digit rate</b>		<b>8-digit rate</b>
	<b>Units</b>	<b>Rate volume units</b>	<b>Rate Time Units</b>	<b>Total volume units</b>
	<b>Please Note:</b> All meters are factory set for gallons/minute rate and gallons total.	Gallons / Minute (GPM) Barrels / Hour (BPH)	Second Minute Hour Day	Gallons Barrels Acre per inch
	<b>Bidirectional</b>	Forward total, Reverse total, Net total		
<b>Power</b>	<b>DC Power</b>	9-36 vdc at 250 mA max., 30 mA average / 125 vdc		
	<b>Battery Backup</b>	Based on requirement		
	<b>AC Power</b>	85-264 vdc, 50/60 Hz, 0.12A		
	<b>Battery</b>	As required		
<b>Options</b>	<b>4-20mA Current Loop</b>	Isolated passive, 24Vdc, 650 maximum current loop		
	<b>HART/4-20mA</b>	HART protocol over 4-20mA line		
<b>Cable</b>	<b>Power/Output</b>	20 ft. (6m) standard length polyurethane-jacketed cable* -- additional length optional		
	<b>Remote Display</b>	10 ft. (3m) standard length polyurethane-jacketed cable* -- additional length optional		
<b>Empty Pipe Detection</b>		Hardware / software conductivity-based		
<b>Regulatory</b>		As required		
<b>Environmental</b>		To be addressed on case-by-case basis		

Specifications subject to change. Please contact Bell Technologies, LLC at 713-465-7575 or [btllcsales@belltechnologiesllc.com](mailto:btllcsales@belltechnologiesllc.com) for the most current date.

\* Wiring length over 20 feet may require special power supply (eg. Battery)